



PVC check valves (with spring)

Solvent socket outlet - EPDM seal ITEM 264

| Ref. | Description | Net W. | Vol. (m ³) | Gross W. | Batch |
|---------|----------------------------|--------|------------------------|----------|-------|
| 1016001 | V ANTIRET ENL S/ENC 20 | 0,136 | 0,01553 | 5,77 | 40 |
| 1016002 | V ANTIRET ENL S/ENC 25 | 0,174 | 0,01553 | 7,31 | 40 |
| 1016003 | V ANTIRET ENL S/ENC 32 | 0,288 | 0,02244 | 9,14 | 30 |
| 1016004 | V ANTIRET ENL S/ENC 40 | 0,483 | 0,02244 | 10,15 | 20 |
| 1016005 | V ANTIRET ENL S/ENC 50 | 0,685 | 0,02244 | 8,71 | 12 |
| 1016006 | V ANTIRET ENL S/ENC 63 | 1,134 | 0,03129 | 11,84 | 10 |
| 1016007 | V ANTIRET ENL S/ENC 75 | 2,246 | 0,03129 | 9,56 | 4 |
| 1016008 | V ANTIRET ENL S/ENC 90 | 3,644 | 0,02244 | 7,78 | 2 |
| 1016059 | V ANTIRET ENL S/ENC 90-110 | 3,924 | 0,02244 | 8,38 | 2 |



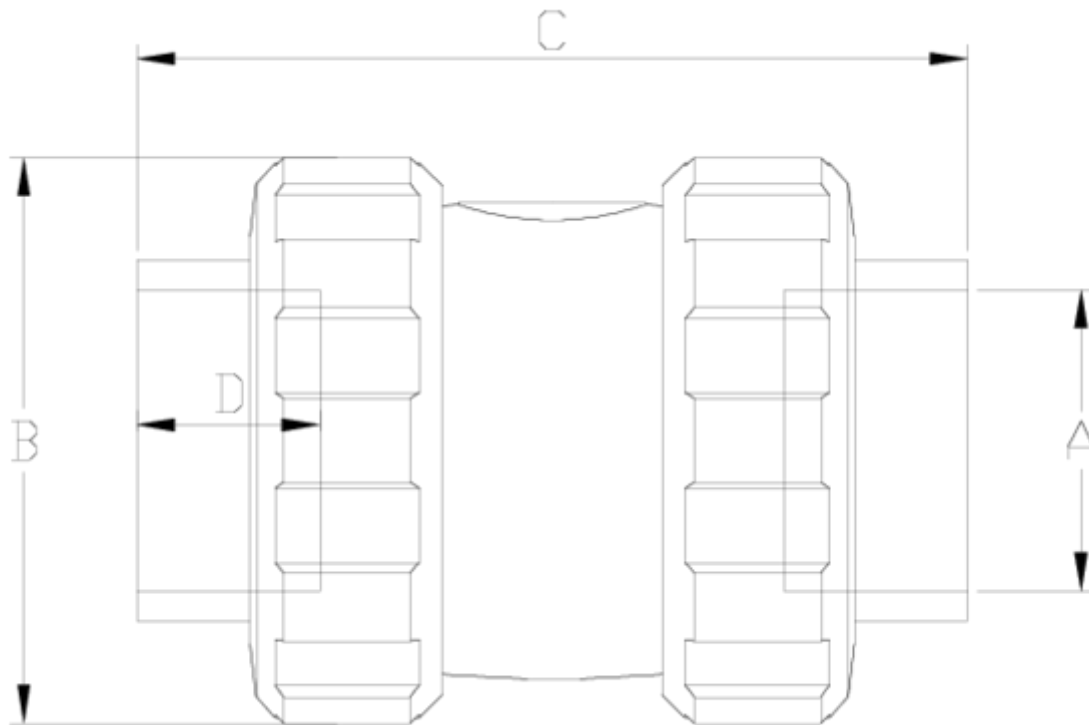

ITEM 264 | Solvent socket outlet - EPDM seal

| Código EPDM | A | Peso | B | C | D | PN | MEDIDA |
|-------------|-----|------|-----|-----|----|------|---------|
| 16001 | 20 | 131 | 52 | 85 | 17 | PN16 | MÉTRICO |
| 16002 | 25 | 174 | 59 | 95 | 19 | PN16 | MÉTRICO |
| 16003 | 32 | 282 | 69 | 120 | 24 | PN16 | MÉTRICO |
| 16004 | 40 | 471 | 85 | 133 | 26 | PN16 | MÉTRICO |
| 16005 | 50 | 677 | 99 | 150 | 31 | PN16 | MÉTRICO |
| 16006 | 63 | 1090 | 116 | 177 | 38 | PN16 | MÉTRICO |
| 16007 | 75 | 2616 | 150 | 216 | 44 | PN10 | MÉTRICO |
| 16008 | 90 | 4194 | 178 | 257 | 51 | PN10 | MÉTRICO |
| 16059 | 110 | 4435 | 178 | 286 | 61 | PN10 | MÉTRICO |